

# Notes:

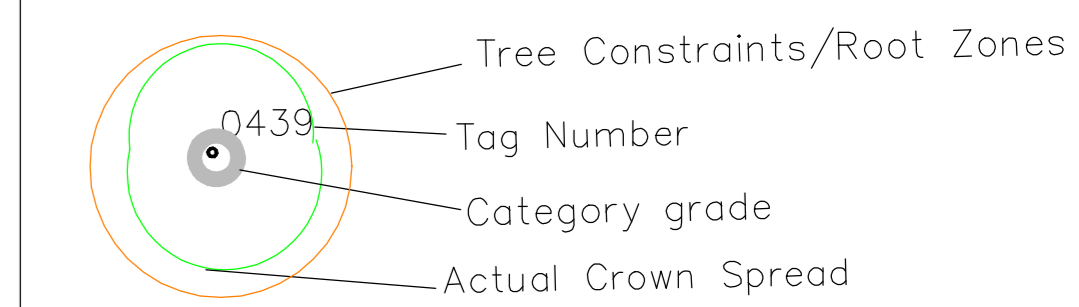

## BS5837: 2012 – Category Retention Rating

- **Category U Trees** – Trees in such a condition that any existing value would be lost within 10 years or being recommended for removal sound arboricultural practice.
  - **Category A Trees** – Trees of high quality/value with a min. of 40 years life expectancy.
  - **Category B Trees** – Trees of moderate quality/value with a min. of 20 years life expectancy.
  - **Category C Trees** – Trees of low quality/value with a min. of 10 years life expectancy.
- Sub Categories**
- 1 – Mainly Arboricultural values
  - 2 – Mainly Landscape values
  - 3 – Mainly cultural and conservation values.

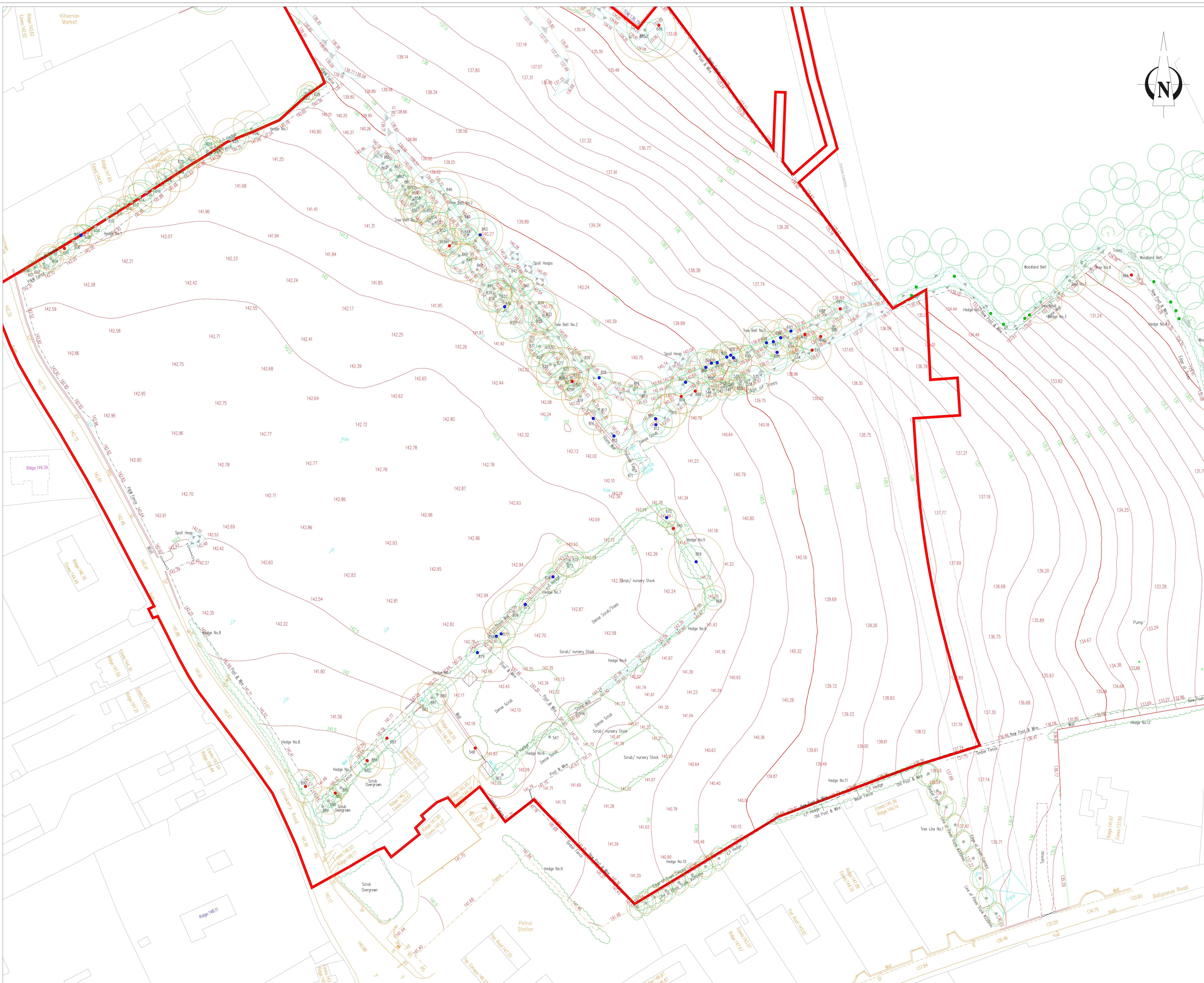
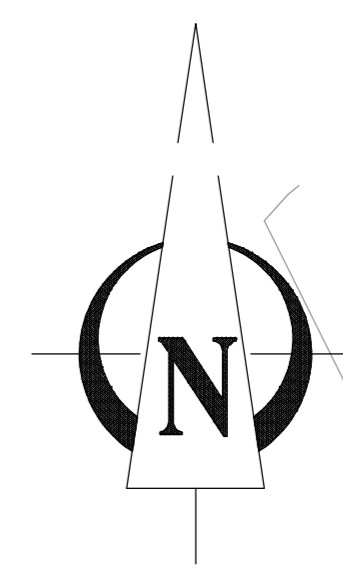

**ARBORIST ASSOCIATES LTD.**  
 94 BALLYBAWN COTTAGES, ENNISKERRY, CO. WICKLOW  
 TEL: 01-2742011 / 087-2629589

**TITLE:** Tree Constraints Plan

**Site:** Kiltiernan Village SHD  
 Residential Development at Lands at  
 Wayside, Enniskerry Rd, Kiltiernan, Dublin 18

**DATE:** Dwg No. KVLO01 Part 2 Scale 1:500 @ A0